

DECwriter Correspondent
Operator Guide
Addendum

This information is a supplement to the DECwriter Correspondent Operator Guide. This addendum notifies our customers that the printhead for the correspondent is NOT customer-replaceable. If the printhead fails, you should call a qualified Digital terminal technician.

The following procedure is to be used by the terminal technician when removing and replacing the printhead.

WARNING

If the terminal has just been used, the printhead may be hot. Wait for five minutes and then be careful when handling.

1. Open access cover and move the printhead to approximate center of the carriage assembly.
2. Remove the ribbon cartridge (Figure 1).
3. Remove the printhead as follows.

CAUTION

The printhead adjust lever and slide are secured to the carriage by the printhead. Be sure that they stay in place when removing the printhead (Figure 2).

- a. Release the printhead clamp in direction of arrow.
 - b. Lift off the printhead from the carriage assembly.
 - c. Remove the two screws from the printhead as shown in Figure 2.
 - d. Disconnect the printhead from the printhead cable connector.
4. Install new printhead by reversing steps 1 through 3.

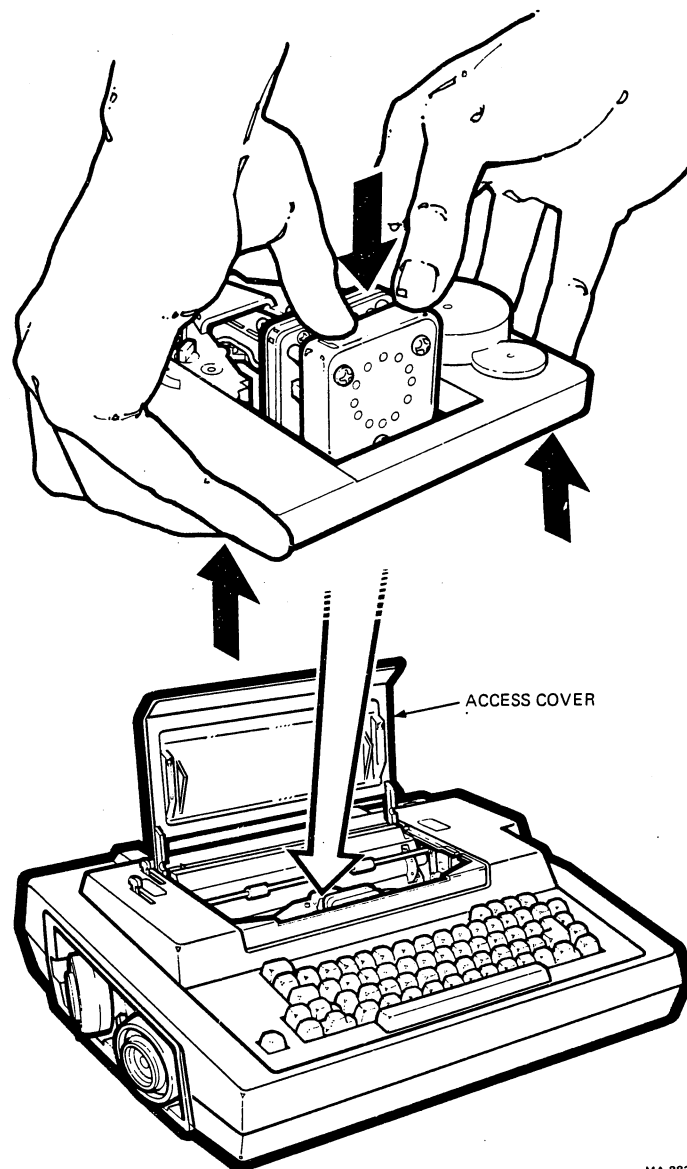

MA-8825

Figure 1 Ribbon Cartridge Removal

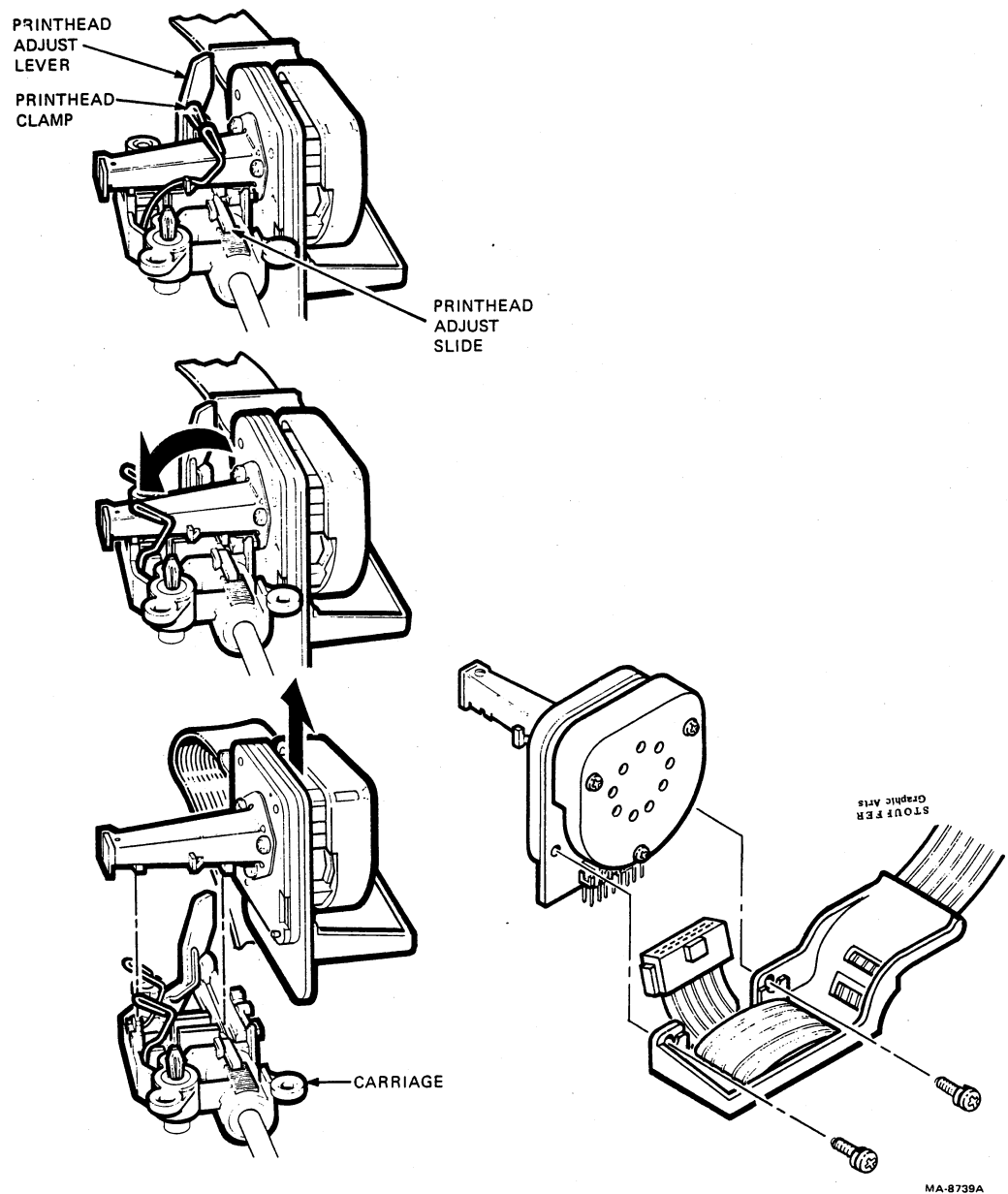

Figure 2 Removing Printhead

In addition to the above, please make the indicated changes on the following pages:

Page 2 - 7-- PAPER ROLL MOUNTING

Add the following note and figure before step 1:

NOTE

When mounting a new small paper roll, remove end caps from used roll. Insert caps in new roll as shown in Figure 2-4A. Large paper rolls do not require end caps.

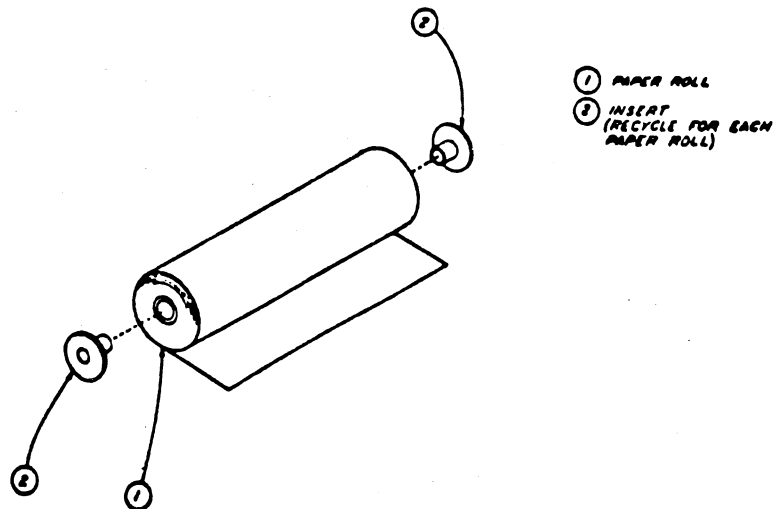

Figure 2-4A Inserting End Caps, Digital Part No. 74-27237-0-0

Page 3 - 30 -- LOCAL ECHO

Add the following note after the procedure for selecting this feature:

NOTE

When local echo is turned on by this procedure, it will be automatically turned off whenever the terminal is turned off. Local echo will remain off when the terminal is turned back on.

To keep local echo on at all times, use the Power Up -- Initial state procedure on page 3 - 17

Page 3 - 17 - Power Up - Initial State

Add the following note after the procedure for selecting this feature:

NOTE

When on line with local echo operation is selected, press the LINE/LOCAL key each time that the terminal is turned on. This step will place the terminal on line.

Local echo will remain on at all times when it is selected as a power up - initial state feature.

Page 3 - 43 -- Table 3 - 7 Feature Default Values

Make the following changes in the table:

Fault Action	XOFF
Speed Select	Low
Keyclick	Yes
Break Key	Yes

Pages 5 - 9, 5 - 14, 5 - 46 -- Analog Loopback Test

Add the following note after each heading - Analog Loopback Test:

NOTE

The loopback test will automatically stop after 2046 characters (26 lines of 10 cpl and 80 cpl) are printed. The message REV TIMEOUT will then be printed. If the test stops before the above limit and the message prints out, there is a fault in terminal operation.

Pages 5 - 9, 5 - 11, 5 - 12 - Test Setup

Add the following note after each heading - Test Setup

NOTE

Be sure to select the HI speed baud rate range (CS-A RETURN) for this test. If the HI range is not selected, the test will not be performed correctly.

If the Lo speed baud rate range is selected by mistake, the test results will be inconclusive. Turn the terminal off and then back on again. Repeat the test.

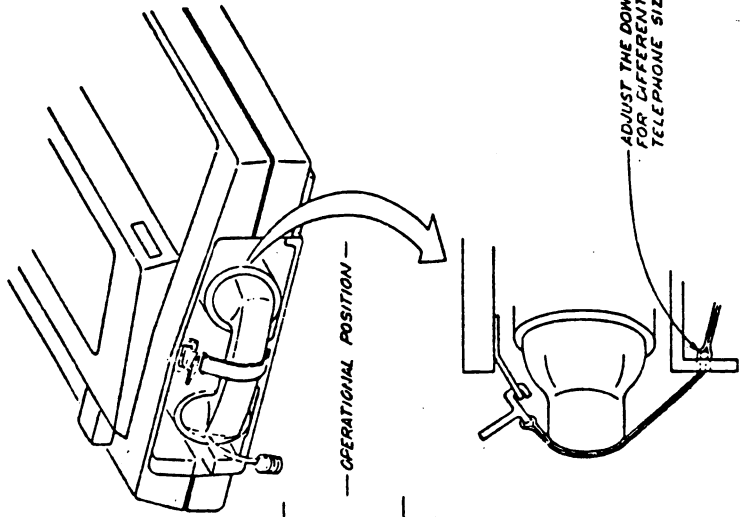

ATTENTION:
THE TELEPHONE HOLDING STRAP SHOULD
BE REMOVED FROM THE SHIPPING POSITION
TO RESET AND ADJUSTED PRIOR TO USE.
ADJUST THE STRAP LENGTH BY SLIDING
THE DOVE PIN IN THE STRAP LOCATED
UNDER THE COUPLER.

[illegible]